



## DESCRIPTION FOR ROUND Ladtech Inc. HDPE Adjustment Ring DESIGNS:

- ☐ Plastic injection molded adjusting ring
- ☐ Molded from high density polyethylene as defined in ASTM specification D1248-84
- ☐ Actual resin properties will vary allowing for the utilization of 100% regrind material
- ☐ The percent of post consumer waste to industrial waste will vary with availability and property retention needs
- ☐ Color, shade, and uniformity will vary with the mix of the post consumer and industrial waste materials

Dimensions shown are normal - actual size will vary within allowable tolerance and required fit

Cone Size	Dim A	Dim B	Dim C	Dim D	Dim E	E = inside hole center to center
24"	33.50"	23.75"	5.00"	23.25"	30 1/4"	
27"	36.50"	26.75"	5.00"	26.25"	33 3/8"	
30"	39.50"	29.75"	5.00"	29.25"	37 1/4"	
32"	41.50"	31.75"	5.00"	31.25"	39 1/2"	
34"	41.50"	33.75"	4.00"	33.25"	39 1/2"	

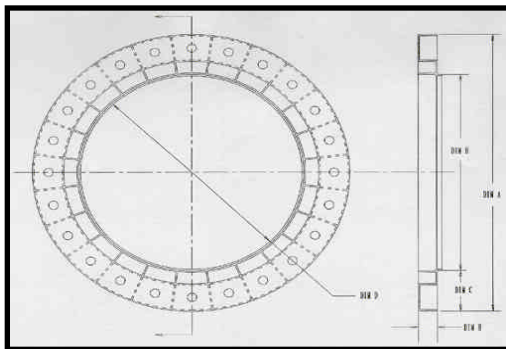

Ladtech Polyethylene flat design

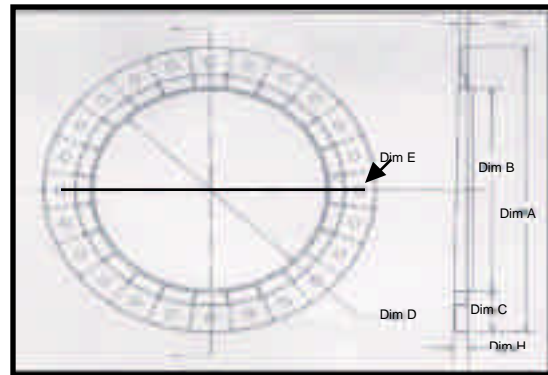

Ladtech Polyethylene Slope design

### Product Compliance Testing for the LADTECH® Injection Molded Recycled High Density Polyethylene Adjusting Rings

Product compliance testing was conducted by American Engineering Testing, Inc. The compressive load carrying capability was confirmed. The rings were successfully loaded up to 60,000 pounds. At that point, with the LADTECH® ring still in serviceable condition, failure of the concrete catch basin and the manhole cover frame assembly halted further testing.

Water penetration tests were also conducted by American Engineering Testing Inc. under ambient laboratory conditions utilizing the approved sealants. When the sealants were properly applied, this testing showed no leakage.

**For more information about testing procedures and existing test results,  
contact LADTECH, Inc. at [www.ladtech.com](http://www.ladtech.com)**